

## 5. REPORT

### Background

5.1 Application by **ERDAL CELEBI**, for a Premises Licence Variation in respect of **90 TRINITY ROAD, LONDON, N22 8YB** under the Licensing Act 2003.

### 5.2 Details of Premises Licence Variation application

#### Supply of Alcohol

Sunday to Thursday 0700 to 0100

Friday and Saturday 0700 to 0200

#### Opening Hours

Sunday to Thursday 0700 to 0100

Friday and Saturday 0700 to 0200

### OPERATING SCHEDULE

#### General

Alcohol will only be sold during operating hours and alcohol will be consumed off the premises.

The premises operates the Challenge 21 Proof of Age Scheme.

### 5.2 Crime and Disorder

CCTV cameras on the premises.

Red Care Alarm System connected to the police via a 24 hours monitoring station to be installed and maintained at the premises.

Customers will not be allowed to congregate outside the premises.

### 5.3 Public Safety

Smoke detectors, fire escape lights and signs, fire extinguishers and fire blankets will be maintained on the premises.

### 5.5 Public Nuisance

All occasions when persons have been refused service will be recorded in a refusals book, which shall be kept at the premises for not less than 12 months.

Suitable signage will be displayed at the point of exit advising customers to leave the premises quietly.

## **5.6 Child Protection**

We will be very strict about not selling alcohol to children and those under age. Where a person appears to be under the age of 21, identification in the form of Passport, Photographic driving licence or a Proof of Age card bearing the PASS hologram will be sought and if not provided service of alcohol will be refused. Suitable signage will be displayed at the point of entry and at the service area advising customers that the premises operates the Challenge 21 Proof of Age scheme.

## **6.0 RELEVANT REPRESENTATIONS (CONSULTATION)**

### **Responsible authorities:**

### **6.1 Comments of Metropolitan Police**

The Police have made representation against this application which has now been withdrawn. **APP 2**

### **6.2 Comments of Enforcement Services**

Have no objections to this application.

#### **Food Team**

Have no objections to this application

#### **Health and Safety**

Have not commented on this application.

#### **Trading Standards**

Have no objections to this application

### **6.3 Fire Officer**

Have not made representation against this application.

### **6.4 Planning Officer**

Planning has no objection to this application.

### **6.5. Comments of Child Protection Agency or Nominee**

Have made comments on the application. **APP 3**

## **7.0 Interested Parties**

1 letter of representation has been received against this application. **APP 4**

## **8.0 Financial Comments**

The fee which would be applicable for this application was **£190.00**

# APPENDIX 1

*read other pages  
may be completed?*

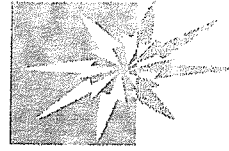

Haringey Council

### Application to vary a premises licence under the Licensing Act 2003

Reference number:

(1)

#### PLEASE READ THE FOLLOWING INSTRUCTIONS FIRST

Before completing this form please read the guidance notes at the end of the form.  
If you are completing this form by hand please write legibly in block capitals. In all cases ensure that your answers are inside the boxes and written in black ink. Use additional sheets if necessary. You may wish to keep a copy of the completed form for your records

(2) I/We

being the premises licence holder, apply to vary  
a premises licence under section 34 of the Licensing Act 2003 for the premises described in  
Part 1 below

Premises licence number

LN00002724

URBAN ENVIRONMENT  
24 MAY 2006  
SCANNED  
TESNORPARK, ASHLEY ROAD, N17 9LH

#### Part 1 - Premises details

Postal address of premises or, if none, Ordnance Survey map reference or description  
80 TRINITY ROAD  
WOOD GREEN

Post town LONDON Postcode N22 8YB

Telephone number at premises (if any)

Non-domestic rateable value of premises £ 8200

#### Part 2 - Applicant details

Daytime contact telephone number

E-mail address (optional)

Current postal address if different from premises address  
ERDAL CELEBI  
123A BOUNDS GREEN ROAD

Post town LONDON Postcode N11 2PP

(1) Insert name and address of relevant licensing authority and its reference number (optional)  
(2) Insert name(s) of applicant

Part 3 - Variation

Please tick  yes

Do you want the proposed variation to have effect as soon as possible?

If not do you want the variation to take effect from

Day	Month	Year

Please describe briefly the nature of the proposed variation (Please read guidance note 1)

THE PREMISES IS LOCATED ON  
90 TRINITY ROAD. PUBLIC TRANSPORT IS  
WELL PROVIDED.

THE PREMISES USES CLASS IS A RETAIL  
GROCERY INCLUDING SALE OF ALCOHOL,  
NEWSPAPER, FRUIT AND VEGETABLE.

THE OPERATION HOURS EVERYDAY BETWEEN  
07:00 AM - 23:00 PM.

FOR PREVENTION OF CHILDREN AND PUBLIC  
SAFETY THERE ARE CCTV IN OPERATION  
RED CARE ALARM SYSTEM FITTED, SMOKE  
DETECTION AND FIRE EXTINGUISHER ALSO  
PROVIDED.

If your proposed variation would mean that 5,000 or more  
people are expected to attend the premises at any one time,  
please state the number expected to attend

**Part 4 - Operating Schedule**

Please complete those parts of the Operating Schedule below which would be subject to change if this application to vary is successful.

**Provision of regulated entertainment**

Please tick  yes

- a) plays (if ticking yes, fill in box A)
- b) films (if ticking yes, fill in box B)
- c) indoor sporting events (if ticking yes, fill in box C)
- d) boxing or wrestling entertainment (if ticking yes, fill in box D)
- e) live music (if ticking yes, fill in box E)
- f) recorded music (if ticking yes, fill in box F)
- g) performances of dance (if ticking yes, fill in box G)
- h) anything of a similar description to that falling within (e), (f) or (g) (if ticking yes, fill in box H)

**Provision of entertainment facilities for:**

- i) making music (if ticking yes, fill in box I)
- j) dancing (if ticking yes, fill in box J)
- k) entertainment of a similar description to that falling within (i) or (j) (if ticking yes, fill in box K)

**Provision of late night refreshment (if ticking yes, fill in box L)**

**Sale by retail of alcohol (if ticking yes, fill in box M)**

**In all cases complete boxes N, O and P**

<b>Late night refreshment</b>			Will the provision of late night refreshment take place indoors or outdoors or both - please tick <input checked="" type="checkbox"/> (please read guidance note 2)
Standard days and timings (please read guidance note 6)			
Day	Start	Finish	Indoors <input type="checkbox"/> Outdoors <input type="checkbox"/> Both <input type="checkbox"/>
Mon			Please give further details here (please read guidance note 3)
Tue			
Wed			State any seasonal variations for the provision of late night refreshment (please read guidance note 4)
Thur			
Fri			Non-standard timings. Where you intend to use the premises for the provision of late night refreshment at different times from those listed in the column on the left, please list (please read guidance note 5)
Sat			
Sun			

## M

<b>Supply of alcohol</b>			Will the sale of alcohol be for consumption - please tick box <input checked="" type="checkbox"/> (please read guidance note 7)
Standard days and timings (please read guidance note 6)			
Day	Start	Finish	On the premises <input type="checkbox"/> Off the premises <input checked="" type="checkbox"/> Both <input type="checkbox"/>
Mon	07:00	01:00	State any seasonal variations for the supply of alcohol (please read guidance note 4)
Tue	07:00	01:00	
Wed	07:00	01:00	Non-standard timings. Where you intend to use the premises for the supply of alcohol at different times from those listed in the column on the left, please list (please read guidance note 5)
Thur	07:00	01:00	
Fri	07:00	02:00	
Sat	07:00	02:00	
Sun	07:00	01:00	



Please highlight any adult entertainment or services, activities, other entertainment or matters ancillary to the use of the premises that may give rise to concern in respect of children. (please read guidance note 6)

0

**Hours premises are open to the public**

Standard days and timings  
(please read guidance note 6)

Day	Start	Finish
Mon	07:00	01:00
Tue	07:00	01:00
Wed	07:00	01:00
Thur	07:00	01:00
Fri	07:00	02:00
Sat	07:00	02:00
Sun	07:00	03:00

State any seasonal variation (please read guidance note 4)

Non-standard timings. Where you intend to use the premises to be open to the public at different times from those listed in the column on the left, please list (please read guidance note 5)

Please identify those conditions currently imposed on the licence which you believe could be removed as a consequence of the proposed variation you are seeking

THIS APPLICATION SEEKS TO EXTEND ON EXISTING LICENCE SALE OF ALCOHOL HOURS OFF THE PREMISES.

THE PROPOSED HOURS ARE SUNDAY TO THURSDAY 07:00 - 01:00 AM  
FRIDAY TO SATURDAY 07:00 AM - 02:00 AM

Please tick  yes

I have enclosed the premises licence

I have enclosed the relevant part of the premises licence

If you have not ticked one of these boxes please fill in reasons for not including the licence, or part of it, below

Reasons why I have failed to enclose the premises licence or relevant part of the premises licence

Describe any additional steps you intend to take to promote the four licensing objectives as a result of the proposed variation:

a) General - all four licensing objectives (b, c, d, e) (please read guidance note 9)

THE ALCOHOL ONLY WILL SALE IN OPERATION HOURS AND ALCOHOL WILL BE CONSUMMED OFF THE PREMISES THE PREMISES OPERATES THE "CHALLENGE 21" THE PROOF OF AGE SCHEME.

b) The prevention of crime and disorder

CCTV CAMERAS ON THE PREMISES, RED CARE ALARM SYSTEM CONNECTED TO THE POLICE VIA A TWENTY FOUR HOURS MONITORING STATION TO BE INSTALLED AND MAINTAINED AT THE PREMISES, COSTUMERS WILL NOT BE ALLOWED TO CONGREGATE OUTSIDE THE PREMISES.

c) Public safety

SMOKE DETECTORS, FIRE ESCAPE LIGHTS AND SIGNS, FIRE EXTINGUISHER AND FIRE BLANKET ALL TO BE MAINTAINED ON PREMISES

d) The prevention of public nuisance

FOR PUBLIC NUISANCE THERE WILL NOT ALLOWED ANY ALCOHOL DRINK AT INSIDE AND OUTSIDE. ALL OCCASIONS WHEN PERSONS HAVE BEEN REFUSED SERVICE WILL BE RECORDED IN A REFUSALS BOOK, WHICH SHALL BE KEPT AT THE PREMISES FOR NOT LESS THAN 12 MONTHS. SUITABLE SIGNAGE WILL BE DISPLAYED AT THE POINT OF EXIT ADVISING COSTUMERS LEAVE PREMISES QUIETLY.

e) The protection of children from harm

WE WILL BE VERY STRICT TO NOT SELL ALCOHOL TO CHILDREN AND UNDER AGE WHERE A PERSON APPEARS TO BE UNDER THE AGE 21, IDENTIFICATION IN THE FORM OF PASSPORT, PHOTO DRIVING LICENCE OR A PROOF OF AGE CARD BEARING THE PASS HOLLOGRAM WILL BE SOUGHT AND IF NOT PROVIDED SERVICE OF ALCOHOL WILL BE REFUSED. SUITABLE SIGNAGE WILL BE DISPLAYED AT THE POINT OF ENTRY AND AT THE SERVICE AREA ADVISING COSTUMERS THAT THE PREMISES OPERATES THE "CHALLENGE 21" PROOF OF AGE SCHEME.

- Please tick  yes
- I have made or enclosed payment of the fee
  - I have sent copies of this application and the plan to responsible authorities and others where applicable
  - I understand that I must now advertise my application
  - I have enclosed the premises licence or relevant part of it or explanation
  - I understand that if I do not comply with the above requirements my application will be rejected

**IT IS AN OFFENCE, LIABLE ON CONVICTION TO A FINE UP TO LEVEL 5 ON THE STANDARD SCALE, UNDER SECTION 158 OF THE LICENSING ACT 2003 TO MAKE A FALSE STATEMENT IN OR IN CONNECTION WITH THIS APPLICATION**

**Part 5 - Signatures** (please read guidance note 10)

Signature of applicant (the current premises licence holder) or applicant's solicitor or other duly authorised agent. (please read guidance note 11)

If signing on behalf of the applicant please state in what capacity.

Signature *[Handwritten Signature]*

Date 20.05.2010

Capacity CEMKA ENGINEERING CO. (AGENT)

Where the premises licence is jointly held signature of 2nd applicant (the current premises licence holder) or 2nd applicant's solicitor or other authorised agent. (please read guidance note 12)

If signing on behalf of the applicant please state in what capacity.

Signature \_\_\_\_\_

Date

Capacity

Contact name (where not previously given) and address for correspondence associated with this application (please read guidance note 13)	
OFFICE 1 HERON HOUSE HALE WHARF FERRY LANE	
Post town <u>LONDON</u>	Postcode <u>N17 9NF</u>
Telephone number (if any) <u>0208 800 2702</u>	
If you would prefer us to correspond with you by e-mail your e-mail address (optional) <u>cemkaeng@gmail.com</u>	

## PREMISES LICENCE

Receipt: F00109019504

Premises Licence Number: LN00002724

*This Premises Licence has been issued by:*

***The Licensing Authority, London Borough of Haringey,  
Civic Centre, High Road, Wood Green,  
London, N22 8LE***

Signature:.....

Date: 17<sup>TH</sup> August 2006

### Part 1 – PREMISES DETAILS

**Postal Address of Premises or, if none, Ordnance Survey map reference or description:**

**90 TRINITY ROAD  
WOOD GREEN  
LONDON  
N22 8YB**

**Where the Licence is time limited, the dates:**

N/A

**Licensable activities authorised by the Licence:**

Supply of Alcohol

**The times the Licence authorises the carrying out of licensable activities:**

Supply of Alcohol

Monday to Sunday            0700 to 2300

**The opening hours of the premises:**

Monday to Sunday            0700 to 2300

**Where the Licence authorises supplies of alcohol whether these are on and/or off supplies:**

Supply of alcohol for consumption **OFF** the premises only

LICENSING ACT 2003

Sec 24

**Part 2**

**Name, (registered) address, telephone number and e-mail (where relevant) of holder of Premises Licence:**

Erdal Celebi  
123A Bounds Green Road  
London  
N11 2PP

**Registered number of holder, for example company number, charity number (where applicable):**

**Name, address and telephone number of designated premises supervisor where the Premises Licence authorises the supply of alcohol:**

Mehmet Gunduz  
90 Downspark Road  
London  
E5 8JE

**Personal Licence number and issuing authority of personal licence held by designated premises supervisor where the Premises Licence authorises for the supply of alcohol:**

Personal Licence Number           LBH-PER-T-0196  
London Borough of Hackney

## **Annex 1 –Mandatory Conditions**

### **Section 19 – Supply of Alcohol**

(2) No supply of alcohol may be made under the premises licence-

- (a) at a time when there is no designated premises supervisor in respect of the premises licence,  
or
- (b) at a time when the designated premises supervisor does not hold a personal licence or his personal licence is suspended.

(3) The second condition is that every supply of alcohol under the premises licence must be made or authorised by a person who holds a personal licence.

## **Annex 2 – Conditions consistent with the Operating Schedule**

### **THE PREVENTION OF CRIME AND DISORDER**

CCTV cameras on the premises.

Red car alarm system connected to the police via a twenty four hour monitoring station to be installed and maintained at the premises.

Customers will not be allowed to congregate outside the premises.

### **PUBLIC SAFETY**

Smoke detectors, fire escape lights and signs, fire extinguisher and fire blanket all to be maintained on premises.

### **THE PREVENTION OF PUBLIC NUISANCE**

No alcohol will be sold to intoxicated individuals.

### **THE PROTECTION OF CHILDREN**

No alcohol to be sold to anyone under the age of 18.

If there is any doubt over the customer's age, a form of I.D providing date of birth will be requested.



### **Annex 3 – Conditions attached after a hearing by the licensing authority**

The Committee decided to grant the application in full and subject to the following conditions.

1. To implement the red care alarm system connected to the police.
2. To prevent undesirable persons from congregating outside the shop.
3. The conditions to enforce the provisions of the operating schedule.
4. The standard of proof will apply if in doubt of any persons age.
5. Statutory mandatory conditions in section 19 of the Licensing Act 2003.

Annex 4 - Plans

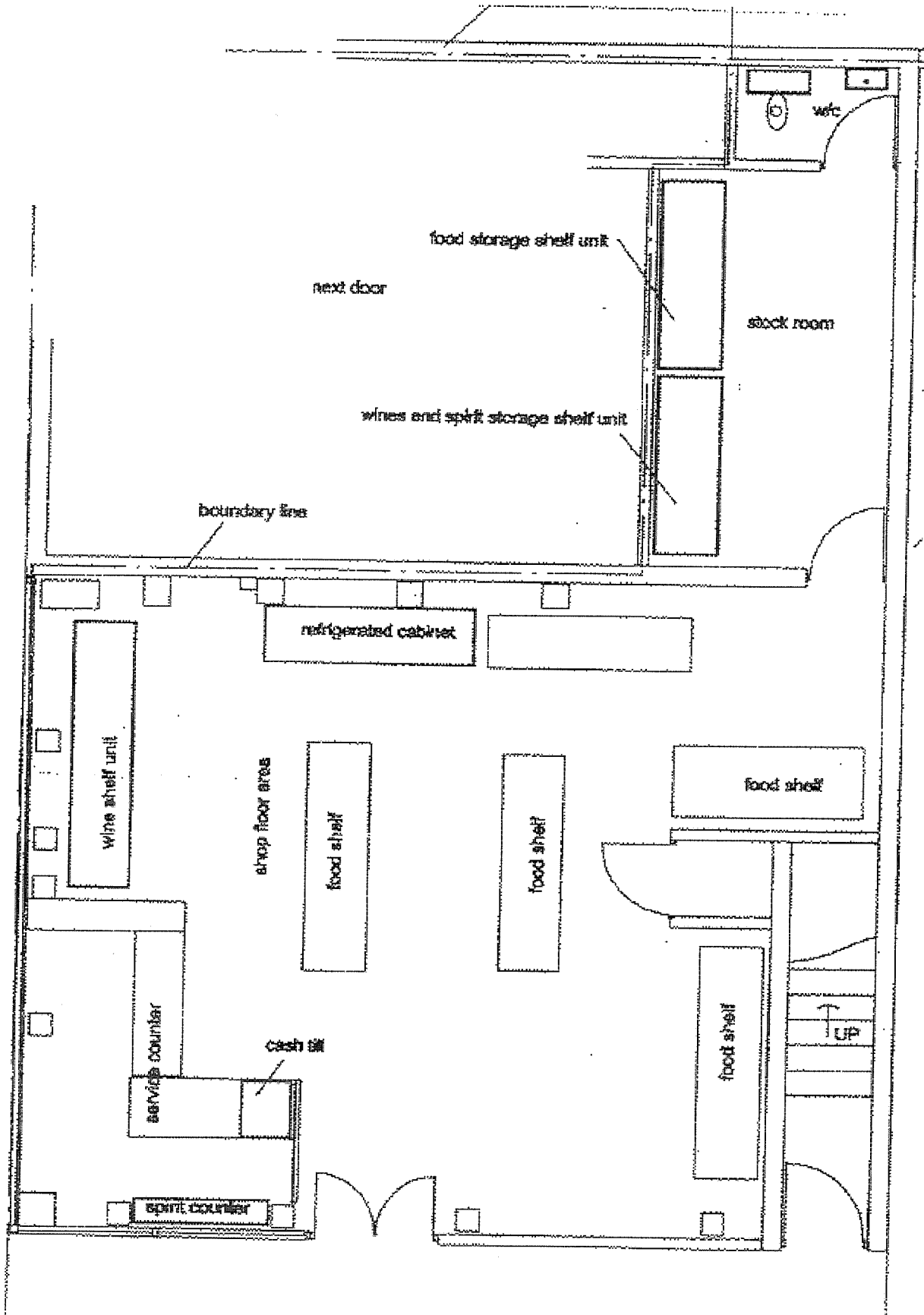

## APPENDIX 2



Your reference:

Our reference: 119/2010

Date: 25 May, 2010

Ms D BARRETT - WILLIAMS  
ENVIRONMENTAL CONTROL SERVICES  
TECHNO PARK  
ASHLEY ROAD  
TOTTENHAM N.17

**Metropolitan Police Service**

*Licensing*  
Quicksilver Patrol Base  
Western Road  
Wood Green  
N.22 6UH

Tel: 0203 – 276 - 0150

Dear Ms. Barrett

**Re:- Application for a Premises Licence:-**

**90 Trinity Road N.22**

With reference to the above application Police have considered the application and wish to make the following representation, this is under the Prevention of Crime & Disorder objective

A minimum of two people working on the premises between 23.00 and closing

If you require further information please do not hesitate to contact me on the above telephone number.

Yours Sincerely

Geoffrey Parker  
Licensing  
Quicksilver Patrol Base

c.c.Cemka Engineering Co

## APPENDIX 3

## Olson Kendra

---

**From:** Painter Jane  
**Sent:** 01 June 2010 17:36  
**To:** Olson Kendra  
**Cc:** Lindsay Tendy  
**Subject:** RE: Application for a Premises Licence Variation for 90 Trinity Road, Wood Green, London N22

Hi Kendra,

The applicant states that they operate the Challenge 21 scheme. They should ensure that a refusals book is kept and that staff receive regular training ( induction and refresher) including asking for proof of age, the refusals book and penalties for sale of alcohol to those under age.

The applicant should also ensure that the organisation has a child protection lead who has attended London Borough of Haringey safeguarding training session and is able to pass on this training to other staff in the organisation.

Kind regards,  
Jane

Jane Painter,  
Young People's Substance Misuse Commissioner,  
6th Floor, Alexandra House, 10 Station Road,  
Wood Green, London, N22 7TR.  
Mondays and Fridays. Tel: 020 8489 6961

Commissioning and Contracts Team,  
River Park House,  
Podium Level,  
225 High Road,  
N22 8HQ  
Tues, Weds and Thurs.  
Tel: 020 8489 3312 ( River Park House)

Fax: 020 8489 2992  
Mobile: 07914896836  
email: jane.painter@haringey.gov.uk

---

**From:** Olson Kendra  
**Sent:** 24 May 2010 13:37  
**To:** Food Haringey; Malcolm Eubert; Osinaike Charley; 'Christopher.Thorpe@met.pnn.police.uk'; Pearce Derek; 'firesafetyregulationNW@london-fire.gov.uk'; Planning Enforcement; Building Control; Enforcement Response; Anderson Chanel; 'Geoffrey.Parker@met.police.uk'; Boeuf Paul  
**Cc:** Barrett Daliah; Painter Jane; Smith Paul  
**Subject:** Application for a Premises Licence Variation for 90 Trinity Road, Wood Green, London N22

Please find attached a copy of a Premises Licence Variation application for the above named property.

Please note that the last day for consultation is the 20<sup>th</sup> June2010.

Regards,

*Kendra Olson*

## APPENDIX 4

Stington Rev  
Bounds Gre  
London N22 8YJ  
Ph/fax (0)20 8381 978  
Caroline@forbury.dia.m.a

June 23rs 2010

Haringey Licensing Dept

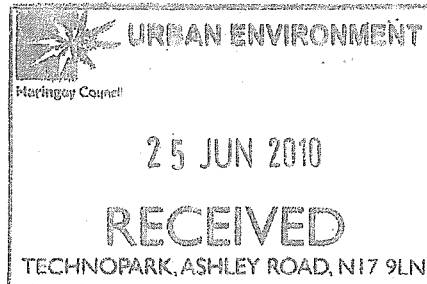

Dear Licensing Dept,

Re 90 Trinity Road.

I enclose my objection to this application and some photos. I realise that this objection is past the deadline which was the 21<sup>st</sup>, but as I told you in my email of the 21<sup>st</sup> (copy attached), it was impossible to see the notice and it had only just been brought to my attention.

Please can this late submission be considered by the panel.

Yours sincerely,

A handwritten signature in cursive script, appearing to read 'Caroline Simpson'.

Caroline Simpson

Cc Cllr Demirci



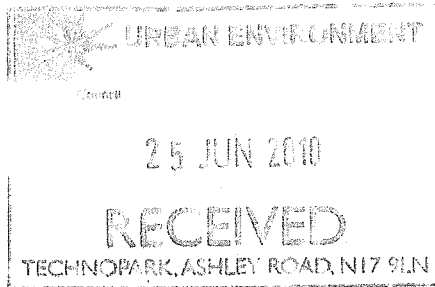

### LICENSING ACT 2003 - REPRESENTATION FORM

To make a representation in respect of an application for a Premises Licence or Club Premises Certificate please complete the following form. For representations to be considered relevant they must relate to one or more of the four "Licensing Objectives" (listed below).

Please note all representations will be made available for applicants to view. If you make a representation objecting to the application it is likely that you will be called upon to attend a hearing and present your objection before a Licensing Committee.

Personal Details
Name <u>CAROLINE SIMPSON</u>
Address <u>9 WHITTINGTON RD</u> <u>LONDON</u>
Postcode <u>N. 22 8YS</u>

Licence application you wish to make a representation on
<i>You do not need to answer all of the questions in this section, but please give as much information as you can:</i>
Application Number.....
Name of Licensee <u>TV CELEBI</u>
Name of Premises (if applicable) <u>90 TRINITY RD</u> <u>Bounds Green Supermarket</u>
Premises Address (where the Licence will take effect)..... <u>90 TRINITY RD</u> <u>BOUNDS GREEN</u>
Postcode..... <u>N. 22</u>

Reason/s for representation
<i>Under the Licensing Act 2003, for a representation to be relevant it must be one that is about the likely effect of the application on the promotion of the four licensing objectives. Any representations that are considered to be vexatious or frivolous will not be considered (please see Haringey Council's leaflet Variations, Representations and Appeals for Premises Licences and Club Premises Certificates).</i>

Fill in reasons for your representation in the space provided under each Licensing Objective it relates to.

The Prevention of Crime and Disorder

The alley beside this shop is already a meeting place for what looks like drug-dealers. Many times, especially in the evenings, I have seen small groups of young men meeting there – and it looks like they are probably there for some purpose apart from a chat, as they skulk round the corner in the alley rather than just chatting outside. I believe that if this extension is allowed then drug-dealing on this corner will be more common. Before the shop opened there was frequent dealing in Whittington Road, opposite my house, and it has moved to the alley and appears to involve younger people and is more often. I know from the Safer Neighbourhood panel meetings and personal observation that there is a lot of drunkenness and drug-dealing late at night outside the late night shops etc by Bounds Green Tube, and this situation will be replicated here. We do not need a replication of what happens on Queens Parade in the early hours here, and because this is less 'public' I believe that both prostitution and drug-dealing would be encouraged.

It will be less safe for people coming home late at night if there are people hanging about on the corner.

Residents near the corner of Whittington Road already experience noise from people leaving the local pub late at night/early in the morning. It often wakes me up. I believe that this extension will lead to more night noise for local people. This is otherwise a quiet residential street and we do not need a shop open selling alcohol till the early hours, especially as a 24 hour shop is only two minutes away by the tube.

It is clear from the attached photos that the licensee has very little regard for the local environment as he has not removed the ugly graffiti from the shop – it has been there a long time. He appears to have very little regard for the effect that his establishment has on the sensitivities of local people. The notice for this extension was also not displayed in a way in which the local public could see it unless they were customers. I believe this also shows the licensee's lack of interest in doing the right thing and his disregard for local people. This attitude makes me think that it is likely that there will be no attempt to ensure good behaviour in the extended hours.

I, Caroline Simpson, hereby declare that all information I have submitted is true and correct.

Signed:

Caroline Simpson

Date:

June 23rd

Please send completed form to:

The Licensing Team  
Enforcement  
Urban Environment  
Units 271-272  
Lee valley Technopark  
Ashley Road  
London  
N17 9LN